

702B/260 Anzac Parade Kensington, NSW

 3  2  1

A Quiet Oasis In The Heart Of Kensington

Renowned as Kensington's premier residential address, Capella offers a perfect blend of urban village convenience and lifestyle appeal. Designed by FJMT Architects and surrounded by landscaped gardens, this stylish three-bedroom apartment is wrapped in wall-to-wall windows maximising natural light and airflow. Streamlined interiors, designer finishes and level lift access makes this spacious contemporary home ideal for the executive family or a prime investment.

Price: \$900 pw

Michael Said

0401 380 858

Double Car Space

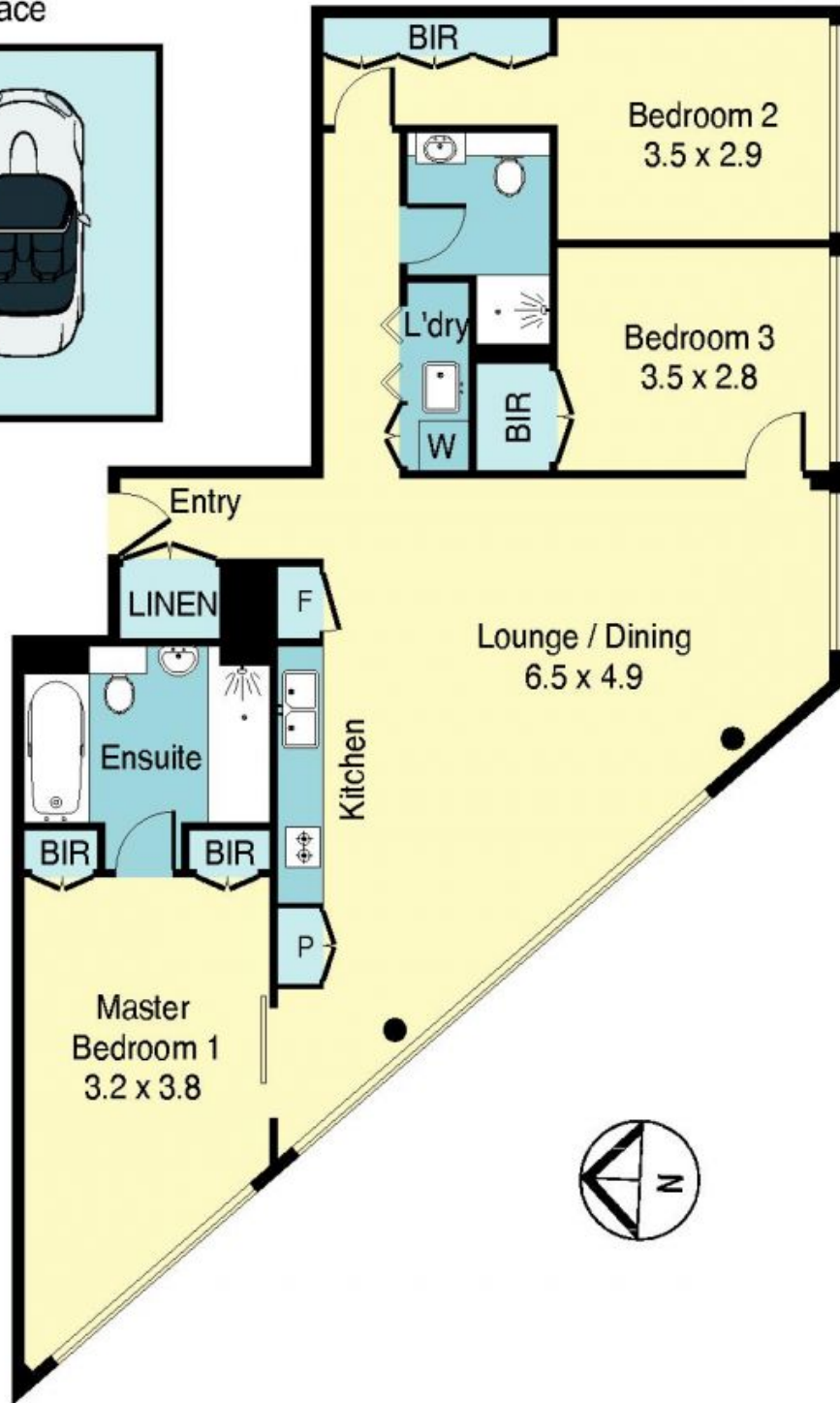
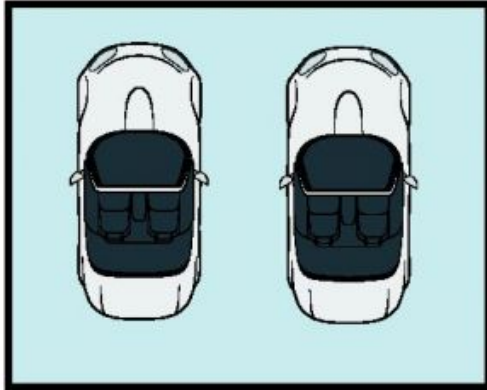

702b/260 Anzac Parade, Kensington

DISCLAIMER: PLANS SHOWN ARE FOR PRESENTATION PURPOSES AND ARE NOT PART OF ANY LEGAL DOCUMENT. ALL MEASUREMENTS AND FIGURES ARE APPROXIMATE.