



33 Douglas Street Clovelly, NSW

 3

 2

 2

### Coastal Bliss: Charming 3 Bedroom Federation Home

Perched aloft a hill in a quiet cul-de-sac rests this charming 3 bedroom Federation home. With expansive neighbourhood views sweeping across Clovelly and Varna Park and boasting a perfect north-east facing block, this property is perfect for those seeking a coastal lifestyle.

**Price:** \$1,650 pw

Capturing bountiful sunlight all day, and positioned close to local shops, beaches, cafes and parklands, this impeccable property features:

- ☑ Three large bedrooms, all with wardrobes
- ☑ Large living and dining area, with large windows & air conditioning
- ☑ Enormous sun-drenched backyard, shed & underground storage
- ☑ Large kitchen with dishwasher & gas cooking
- ☑ Set in a quiet cul-de-sac perfect for families
- ☑ Rear entertaining deck capturing sun & panoramic district views

**Kira Graham**

0432 171 559

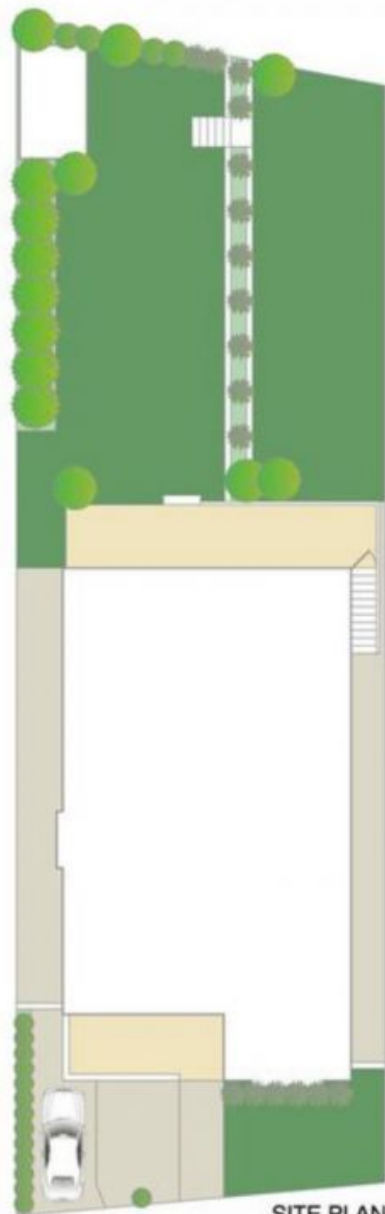
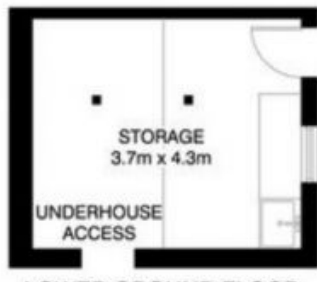
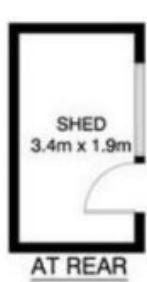

# CLOVELLY

## 33 DOUGLAS STREET



\*PLANS SHOWN ONLY INDICATIVE OF LAYOUT. DIMENSIONS ARE APPROXIMATE.

Floor plan supplied by V-Mark Design Pty Ltd. This floor plan is provided for indicative purposes only.

Measurements are approximate and not to scale. The vendor, agency and supplier will accept no liability for its accuracy. Interested parties are advised to make their own independent enquiries.